



# THETFORD FARM ESTATE

L I N C O L N S H I R E

THE CORPORATE BROCHURE

DESIGNED & BUILT FOR YOU

# ALL ABOUT THE VENUE

- I The Venue
- 2 - 5 The Conference Barn
- 6 - 8 The Corporate Suite
- 9 The Green Room
- 10 - 11 The Courtyards
- 12 - 13 The Boardroom
- 14 - 15 The Pod
- 16 Corporate Days
- 17 Catering
- 18 Pricing
- 19 Location





# THE VENUE

---

## About Us

Thetford Farm Estate is a large barn venue set in the 500 acres grounds of a working arable farm in South Lincolnshire. Surrounded by field views, the 200 year old barns and surrounding area have been expertly renovated, retaining their traditional heritage but with the contemporary elements essential to every modern business.

Completed in June 2024, the 10'500m2 space, consisting of The Conference Barn, large Corporate Suite/Showroom, three breakout spaces and two courtyards, one of which is fully enclosed and leading directly off the corporate suite itself, providing the space and versatility to accommodate any event.

# THE CONFERENCE BARN

The Conference Barn is a 200 year old grainstore barn that has been expertly renovated into a large, conferencing facility. With its traditional exposed brickwork, original beams and doorways, the barn itself is rustic with a modern high-end finish. With a double height ceiling and natural acoustics, it is an impressive space to create impact for your clients. The lighting has been advised by industry specialists and a refreshment area is available on request.



## SUITABILITY

- Conferencing
- Exhibitions
- Dining
- Speaker Events
- Training Sessions
- Award Ceremonies
- Team Building
- Product Launches
- Product Demonstration
- Trade Shows
- Network Events
- Concerts
- Proms
- Car Shows
- Christmas Parties

# THE CONFERENCE BARN

## CAPACITY & KEY FEATURES



CORPORATE &  
CONFERENCES

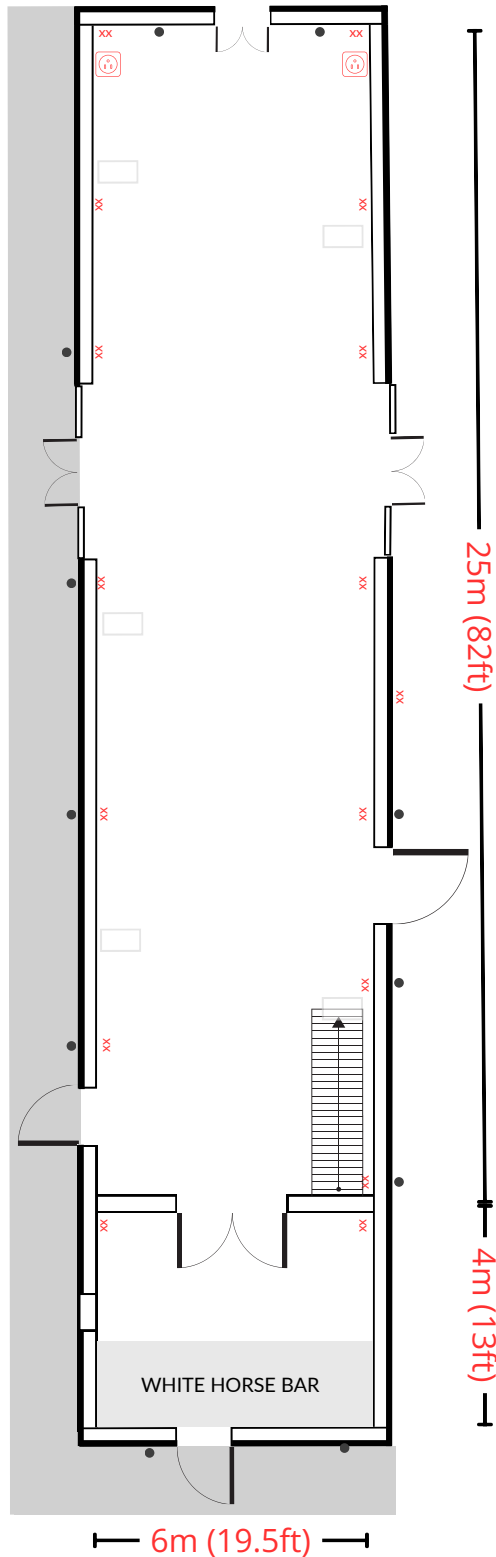

### THE BARN

- Seating - 200+
- Standing Room - 250+
- Room Dimensions - 25m x 6m (82ft x 19.5ft)
- Ceiling Height - Approx 8m (26ft)
- Door Height - Approx 2m (6.5ft)
- Door Width - Approx 2.6m (8.5ft)
- Power Points - 13 Double Sockets
- Three-Phase Power Supply
- Sound - Full Bluetooth PA System with isolation availability
- 1000 Megabyte Super-Fast WiFi
- Lighting - Wall Mounted Lighting
- Wheelchair Access throughout
- The White Horse Bar, staffed & stocked on request

### THE HAYLOFT

- Mezzanine level space
- 3/4 size Snooker/Dining table
- Leather Chesterfield Sofas & Chairs

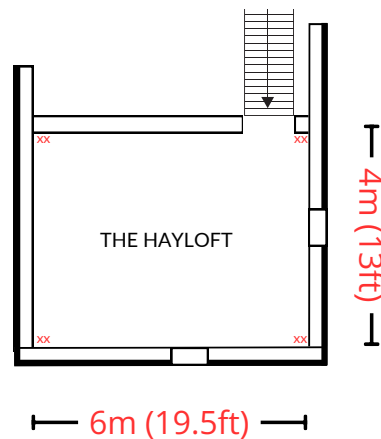

# THE CONFERENCE BARN

## LAYOUT OPTIONS

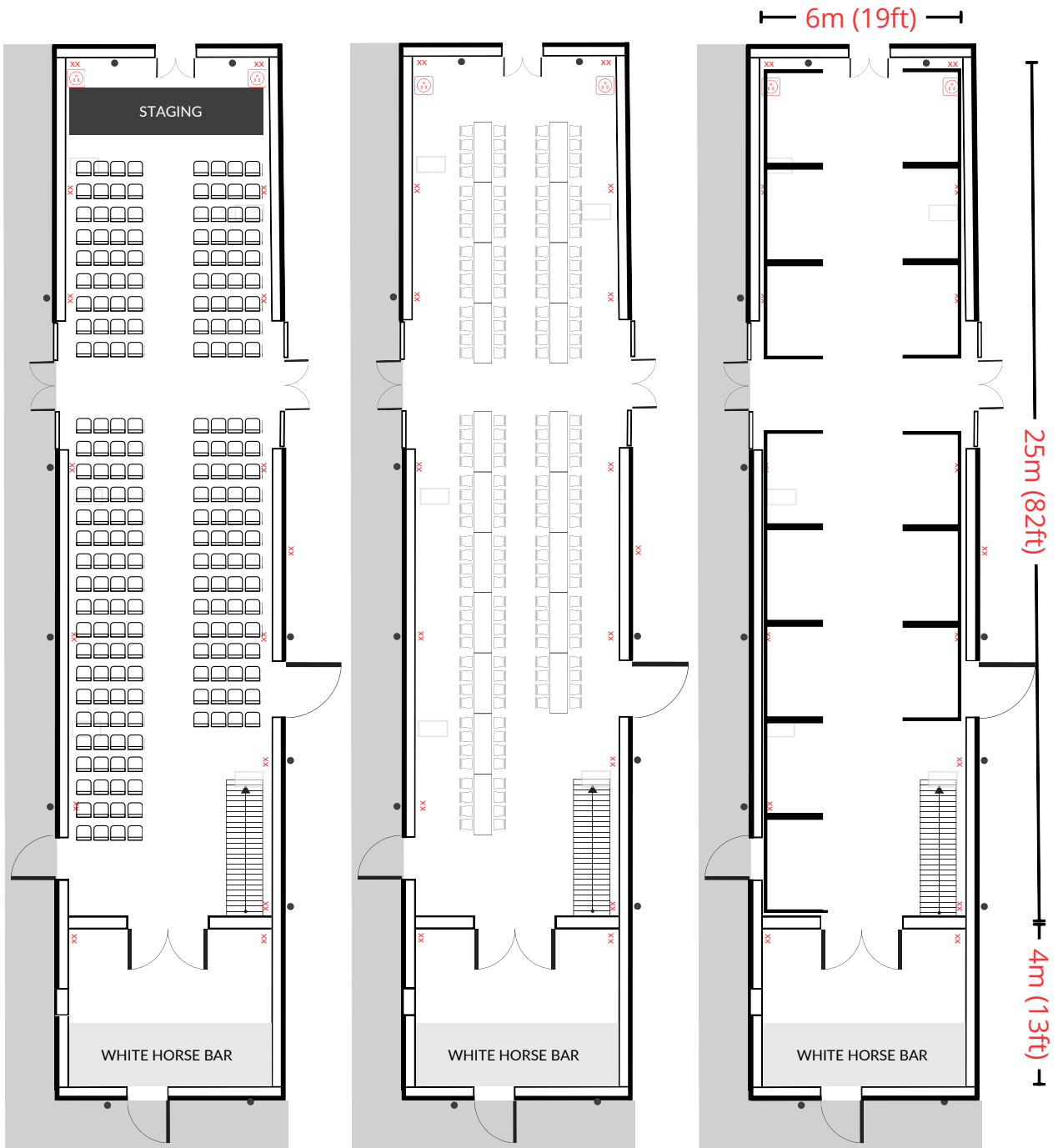

THEATRE STYLE SEATING  
WITH STAGING

LONG BANQUETING  
TABLES

TRADE STANDS



# THE CORPORATE SUITE

The Corporate Suite is a large space, ideal for dining events, demonstrations, exhibitions and even car shows. The floor has been reinforced to allow room for 3+ vehicles and over 10 tonnes distributed weight.



## CAPACITY & KEY FEATURES

- Seating - 180+
- Room Dimensions - 20m x 10m (65 x 32ft)
- Ceiling Height - Approx. 2.5m (8.2ft)
- Door Height - Approx. 2m (6.5ft)
- Door Width - Approx. 1.3m (4ft)
- Power points - 6 Double Sockets
- Sound - Full Bluetooth PA System with isolation available
- 1000 Megabyte Super-Fast WiFi
- 85" Smart 4K Ultra HD Screen
- Lighting - Wall Mounted, Decorative Pendant & Dimmable lighting throughout
- Wheelchair Access throughout
- Reinforced floor - over 10 tonnes distributed weight
- 8 Sliding Glass Doors - 1.4 x 2.3m (4.5 x 7.5ft)
- Direct Access to The Enclosed Courtyard

# THE CORPORATE SUITE LAYOUT

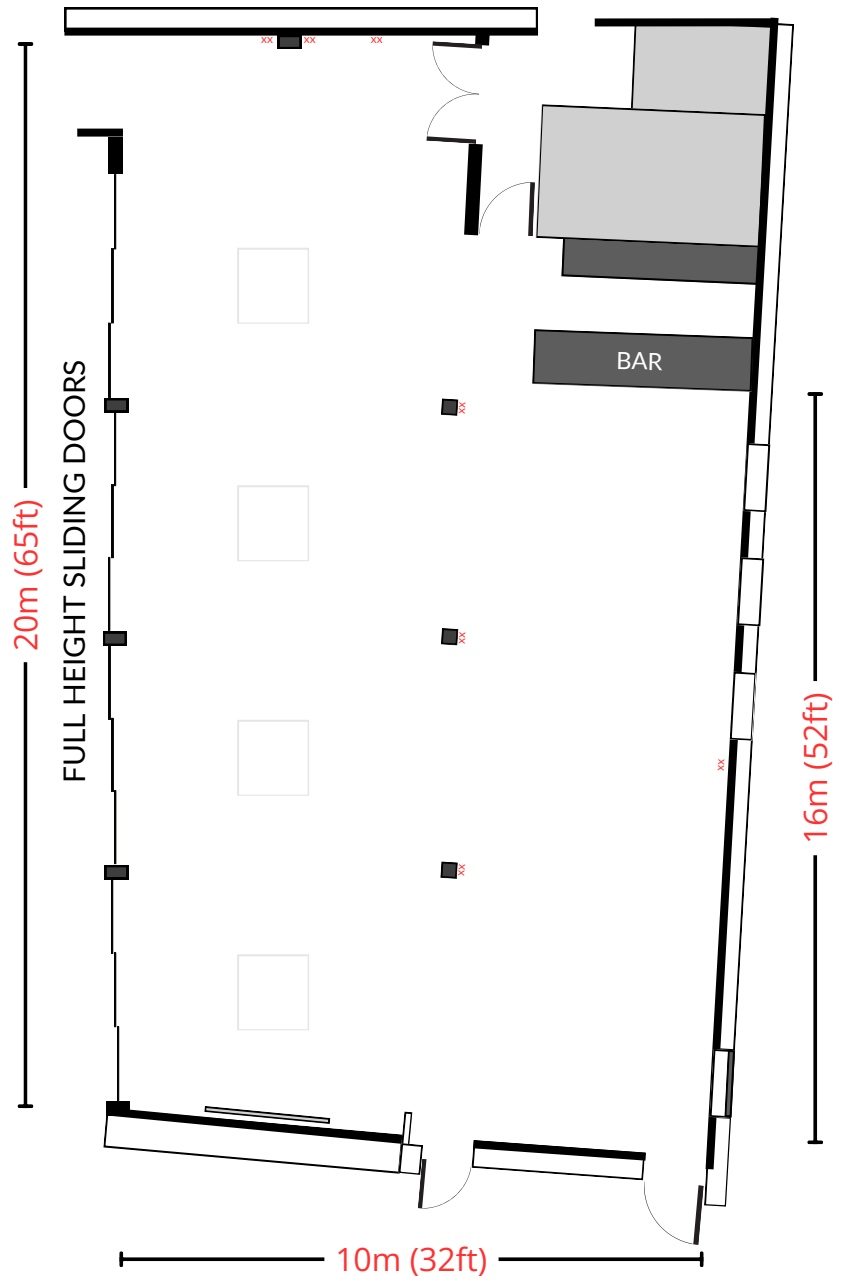



# THE CORPORATE SUITE LAYOUT SUGGESTIONS



CORPORATE &  
CONFERENCES

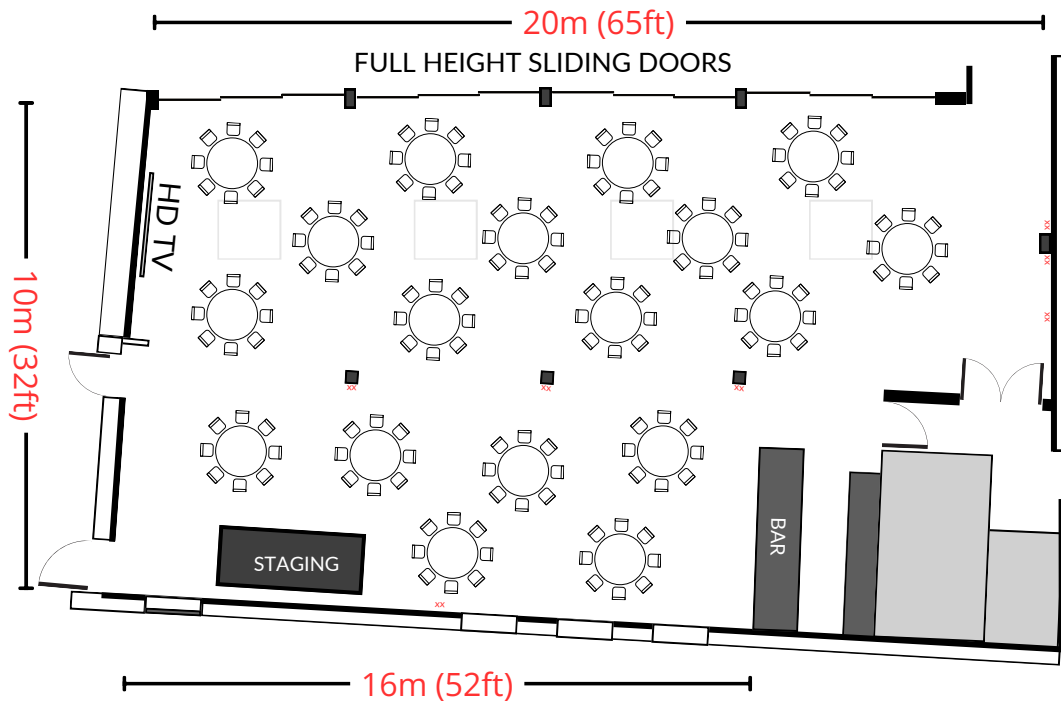

180 guest  
Seating

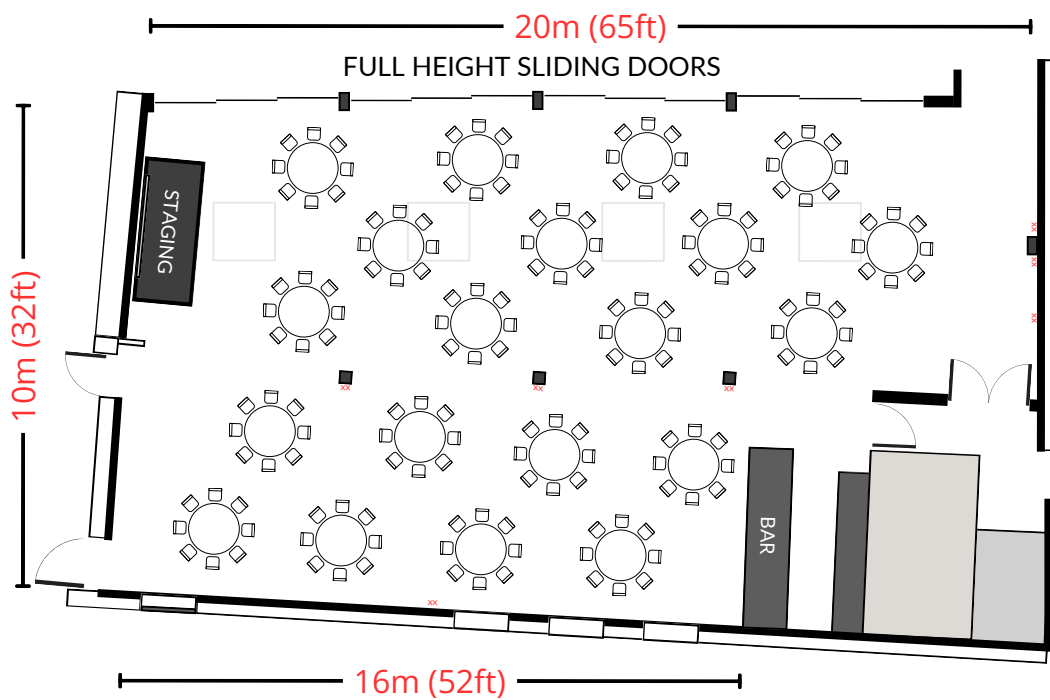

200 guest  
Seating

# THE GREEN ROOM

*The perfect space in which performers, guest speakers and event staff can relax, gather their thoughts and prepare, before, during and after an event.*

- Approx. 3 x 6.5m (10 x 21ft)
- Private En-suite shower room
- Fully air-conditioned
- Bar worktop
- Power points
- Tea & Coffee facilities

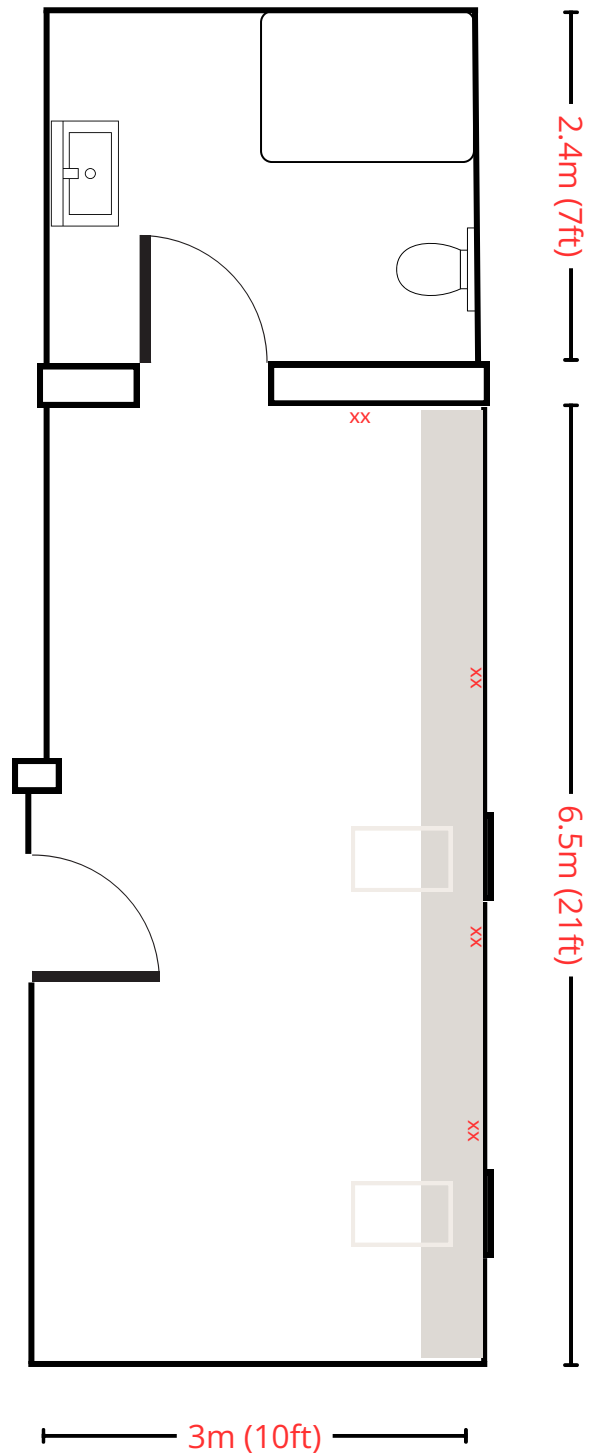

# THE COURTYARDS

With 2 gravel courtyards connected to the barn complex, there is the scope to use these external spaces to their full advantage. Ideal for trade shows, outdoor events or demonstrations, both can be covered to create a larger 'internal' event space.



# THE COURTYARDS LAYOUT

## COURTYARD 1

- Approx. 30 x 22m (98 x 72ft)
- Laid Gravel surface
- Accessible pathway
- Marquee anchor points
- Vehicle access
- Power points
- Water

## COURTYARD 2

- Approx. 18 x 25m (59 x 82ft)
- Fully Enclosed
- Private Access
- Paved patio leading directly off the Corporate Suite via full height sliding glass doors
- Compacted Gravel surface
- Marquee anchor points
- Power points
- Lighting

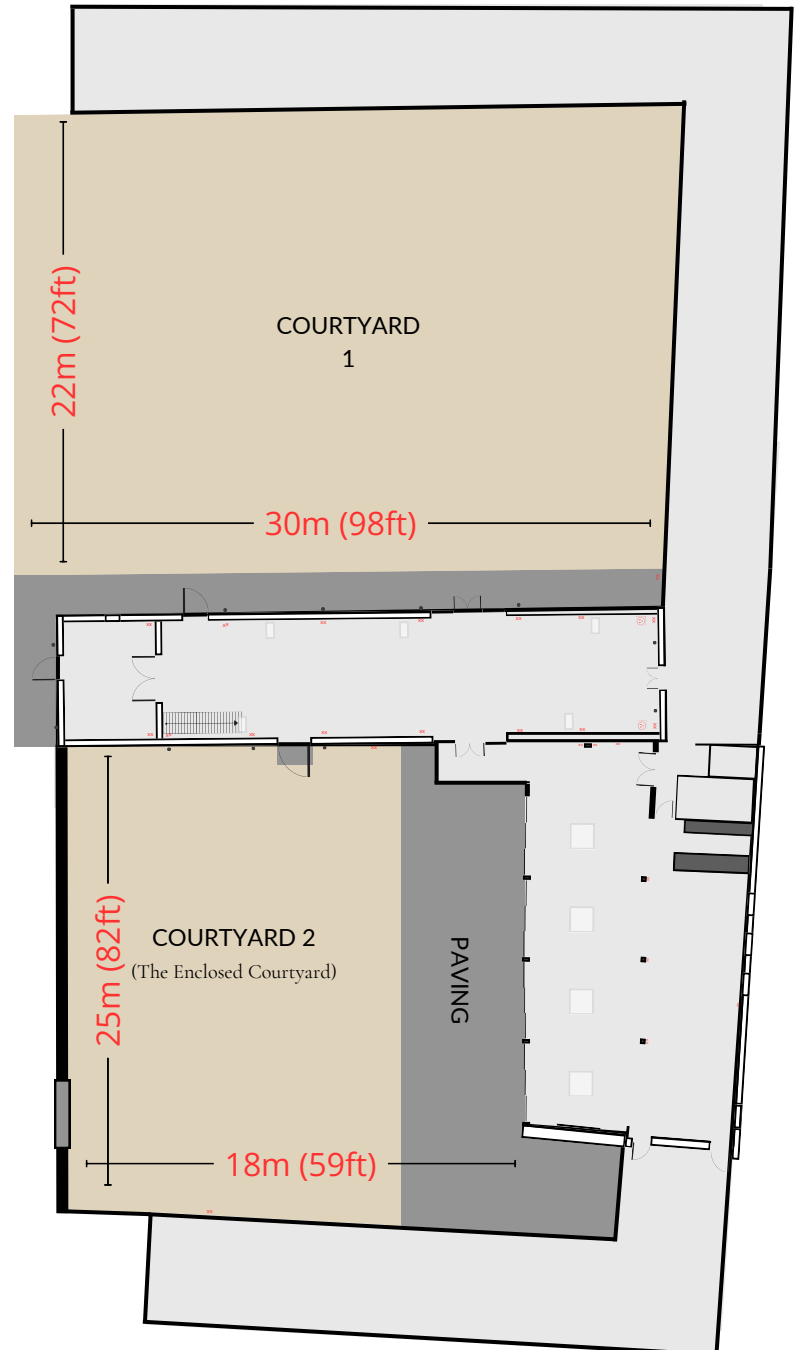



## THE ESTATE BOARDROOM

Situated in the Dutch Barn, The Estate Boardroom will allow for up to 30 people and is available to hire for all your meeting needs. Providing a versatile space for meetings, presentations, classroom style working, video conferencing and more.

### INCLUDED

- 1000 Megabyte Super-Fast WiFi
- 75" Smart 4K Ultra HD Screen
- 4K Video Conferencing with Zoom or Teams
- Screen sharing capability from laptop or mobile device
- Whiteboard
- Flip Chart
- Kitchen facilities
- Wheelchair Access
- Free parking
- Coffee machine
- Catering options for breakfast, lunch & sweet treats during your meeting. Supplied by our in-house catering team.

# THE ESTATE BOARDROOM LAYOUT

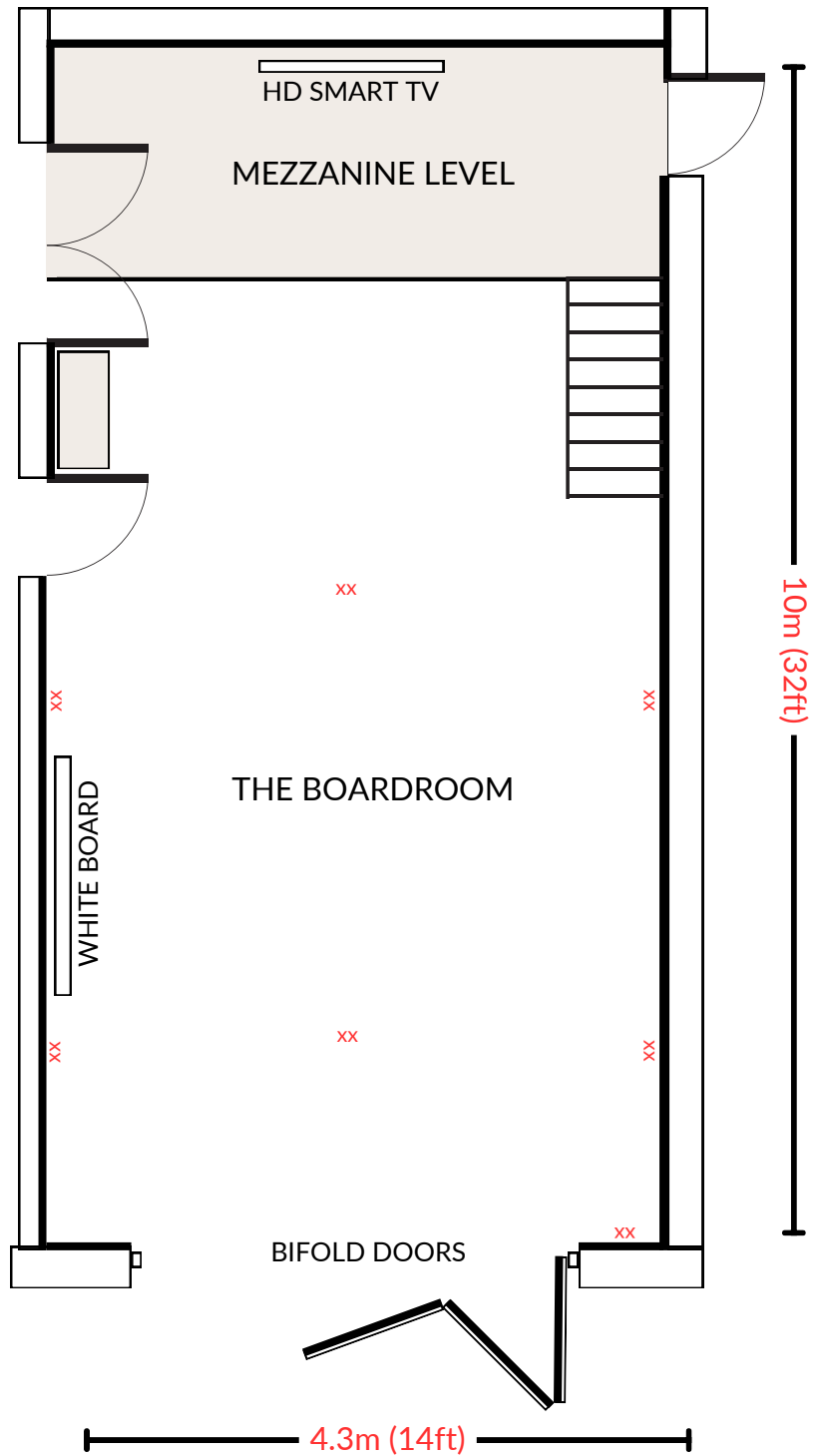



# THE POD

Situated in the Dutch Barn, The Pod is an ideal break-out space for smaller meetings and information sharing events.



## SUITABILITY

- Self contained
- 10 X 4.3m (32 x 14ft)
- Toilet
- Kitchenette
- Coffee machine
- Power (sockets)
- 1000 Megabyte Super-Fast WiFi

# THE POD LAYOUT

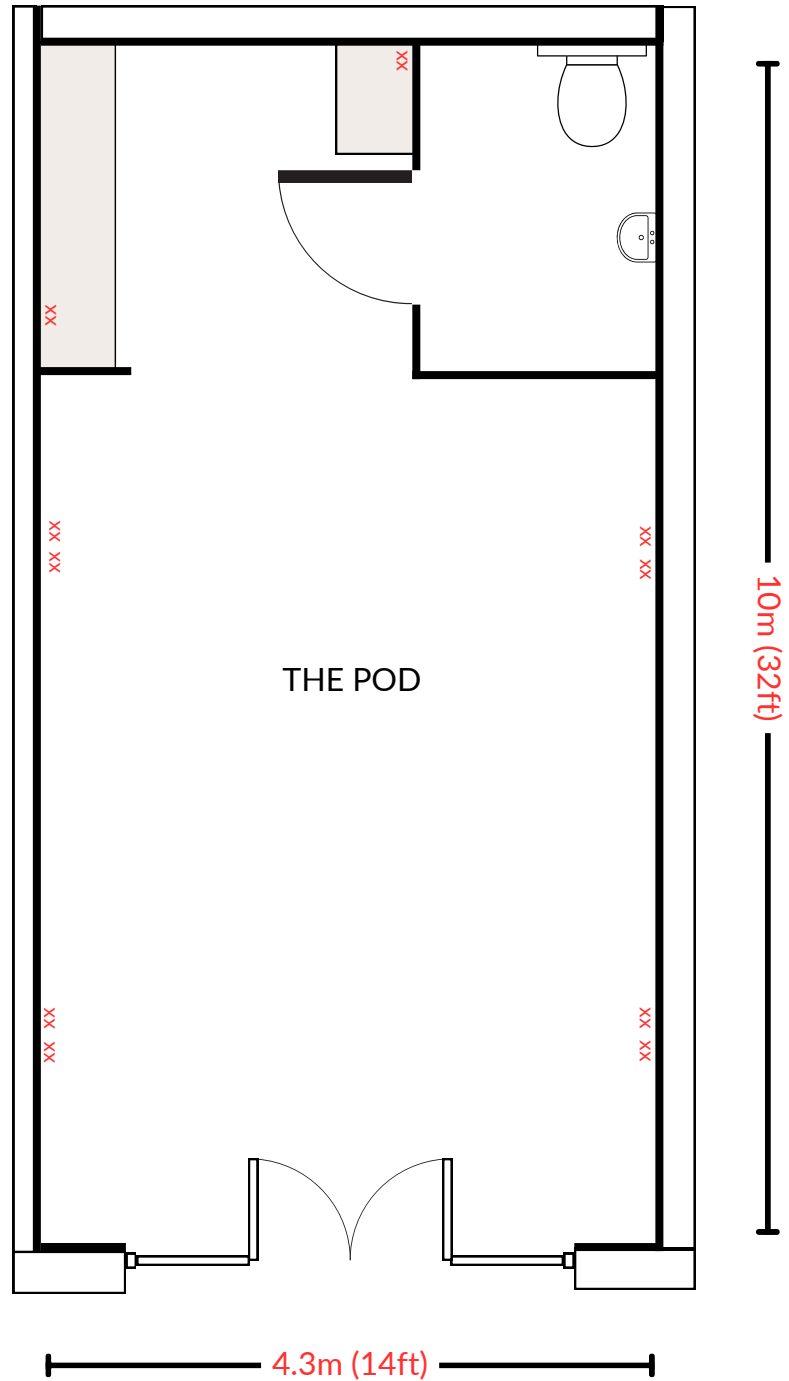

# CORPORATE DAYS

Surrounded by beautiful Lincolnshire countryside we are the ideal venue for you to host your Team Building Day.

Let us put you in touch with an experienced corporate events team and offer you the flexibility and space to make the most of your day.

**For an unforgettable corporate day, where the possibilities are endless.**



- Images supplied by

# CATERING



We can cater from 5 to 500 delegates, providing for all your catering needs. From canapés and breakfast pastries to outdoor barbeques and seven course taster menus.



We have our own in house catering team and also work in partnership with experienced catering companies, to provide the very best for your event.



- Breakfast Pastries
- Buffet Lunch
- Mid-morning/afternoon refreshments
- Summer BBQ
- Gala Dinner
- Fine Dining Evenings
- Seven Course Taster Menus

Please ask for sample menus & costs

# PRICING

## Midweek Bookings – Tuesday, Wednesday, Thursday Weekend Bookings – Friday, Saturday, Sunday

	MIDWEEK (PRICES STARTING FROM:)	WEEKEND (PRICES STARTING FROM:)
JANUARY - MARCH	£6,500	£8,750
APRIL - SEPTEMBER	£8,500	£10,750
OCTOBER - NOVEMBER	£7,000	£8,750
DECEMBER	£7,500	£9,500

- Exclusive use of our private venue
- The Conference Barn for 200+ seated delegates
- The Corporate Suite for 180+ seated delegates
- Combined space for 400+ guests
- The Hayloft, with 3/4 size snooker/dining table
- The Green Room with en-suite shower room
- 75” Smart 4K Ultra HD Screen
- Full Bluetooth PA System with isolation available
- 1000 Megabyte Super-Fast WiFi
- Full use of our catering kitchen
- Full PA system throughout The Barns
- Beautifully designed cloakrooms & accessible suite with baby changing
- Car park for 120 cars
- 12 EV Charging points -Tesla compatible - 7kW/hr

### ON REQUEST

- The Estate Boardroom
- The Pod
- The White Horse Bar, stocked & staffed on request
- Caterers or catering equipment cutlery, crockery, glassware, table linen
- Marquees
- Taxis & coaches available on request

*Corporate Packages, Delegate Day Rates, Boardroom Hire, T&C  
available on request.*

# LOCATION

## DISTANCES:

- Peterborough 11 mi
- Central London 85 mi
- Stamford 7 mi
- Birmingham 67 mi
- Leicester 33 mi
- Nottingham 36 mi
- Leeds 89 mi
- Lincoln 36 mi
- Cambridge 41 mi
- Luton 58 mi
- Stansted 63 mi
- Edinburgh 311 mi

## RAIL LINKS:

Direct rail links from Peterborough to:

- London
- Cambridge
- Birmingham
- Nottingham
- Leicester
- York
- Edinburgh

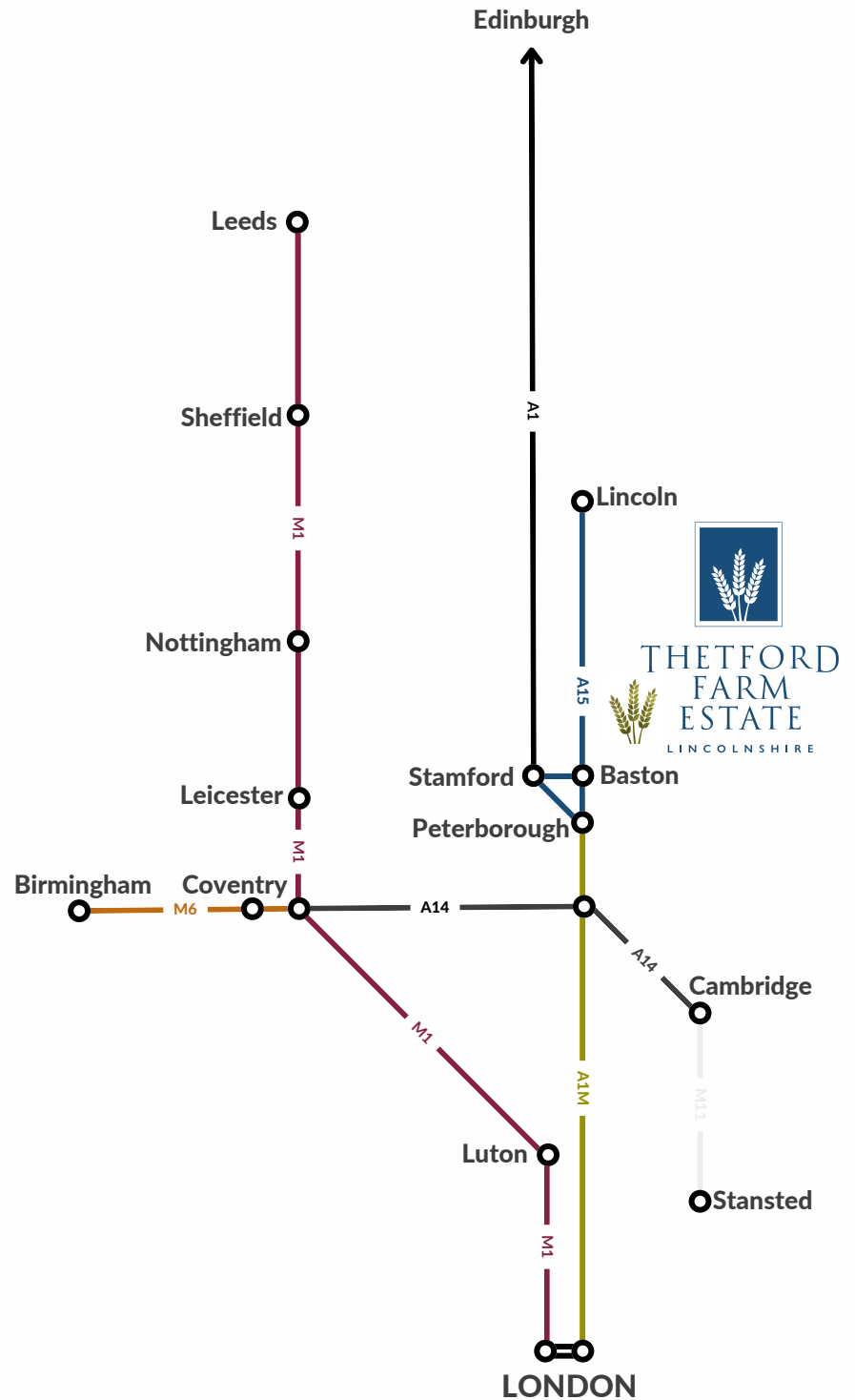





THETFORD  
FARM  
ESTATE  
L I N C O L N S H I R E

DESIGNED & BUILT FOR YOU

**FIND US:**  
Thetford Farm Barn  
Baston, Lincolnshire  
PE6 9NU

**CONTACT US:**  
[team@thetfordfarmbarn.co.uk](mailto:team@thetfordfarmbarn.co.uk)  
01778 594 222

**THETFORD FARM BARN**  
Part of Thetford Farm Estate, owners  
of The White Horse Pub in Baston